

2.2 EXTERIOR SECTION

1

2

3

4

A

B

C

D

E

F

Refer to
"2.3 CONTROL PANEL SECTION".

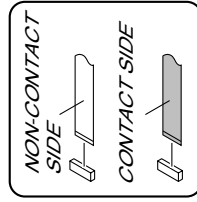
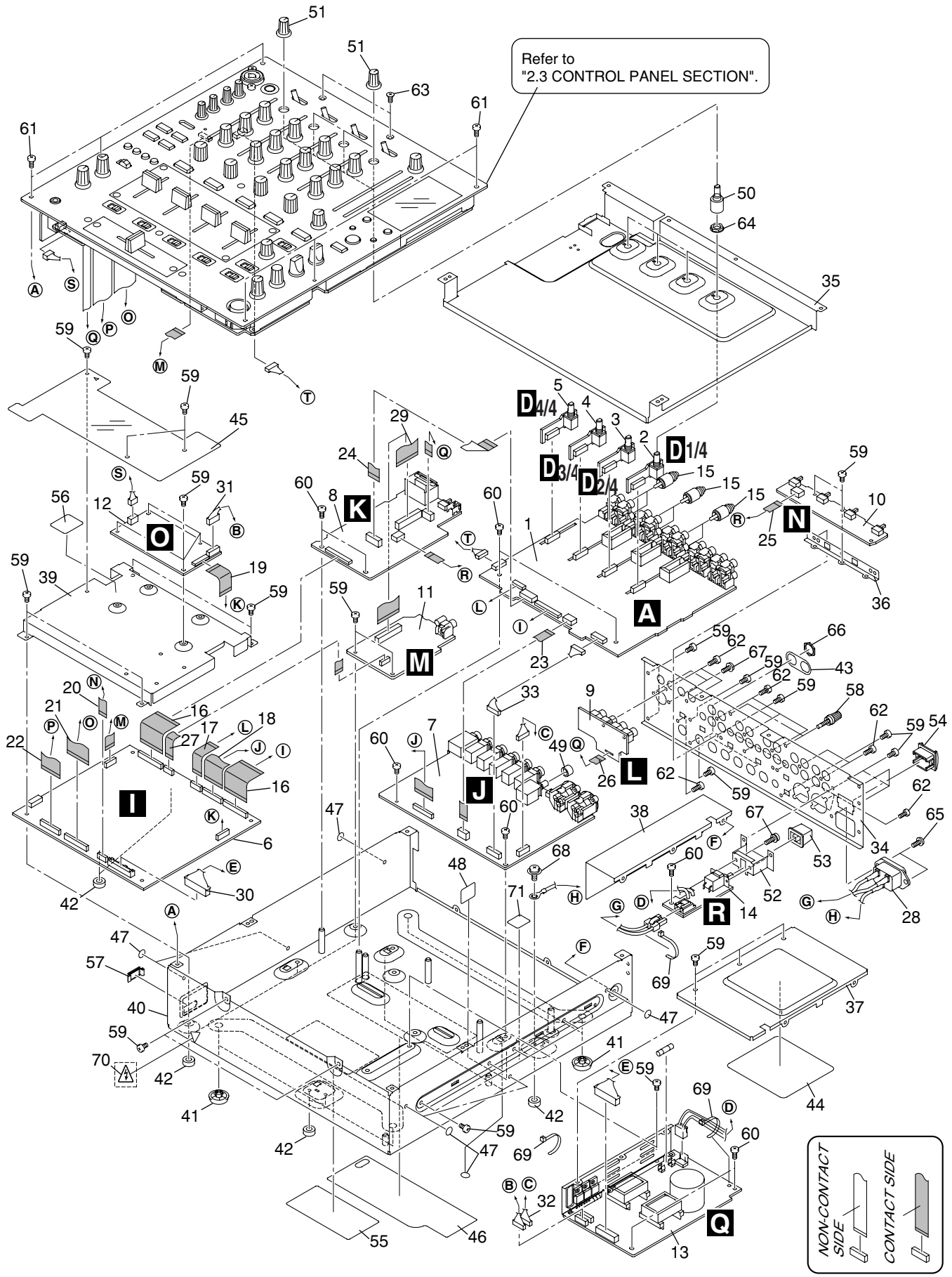

1

2

3

4

5 6 7 8

EXTERIOR SECTION PARTS LIST

Mark No.	Description	Part No.	Mark No.	Description	Part No.
1	INPUT Assy	DWX2535	37	Shield Case	DNH2697
2	TRIM 4 Assy	DWX2551	38	Shield Case AC	DNH2698
3	TRIM 3 Assy	DWX2550	39	Shield Case DSP	DNH2699
4	TRIM 2 Assy	DWX2549	40	Chassis Assy	DXB1881
5	TRIM 1 Assy	DWX2548	41	Leg Assy	REC-434
6	DSP Assy	DWX2534	NSP 42	Spacer	AEB7092
7	OUTPUT Assy	DWX2544	43	PHONE Spacer	DEC2914
8	DIGIC Assy	DWX2547	44	Barrier A	DEC2915
9	DIGIA Assy	DWX2555	45	Styling Sheet	DEC2917
10	SLSW Assy	DWX2536	46	Bottom Cover	DEC2918
11	DIGIB Assy	DWX2546	47	Blind Label	DEC2928
12	HPAMP Assy	DWX2556	48	Barrier B	DEC2944
△ 13	POWER SUPPLY Unit	DWR1433	49	Select Knob (S)	DAA1166
14	ACSW Assy	DWX2545	50	Extension Shaft	DNK4691
15	Short Pin Plug	AKM7008	51	Rotary SW Knob S	DAA1204
16	Flexible Cable (31P)	DDD1316	52	Bracket PSW	DNF1730
17	Flexible Cable (12P)	DDD1317	53	POWER Knob	DAC2306
18	Flexible Cable (25P)	DDD1318	54	POWER Knob Guard	DNK4534
19	Flexible Cable (16P)	DDD1319	NSP 55	LABEL	See Contrast table (2)
20	Flexible Cable (10P)	DDD1321	56	CAUTION Label	DRW2312
21	Flexible Cable (30P)	DDD1322	57	Blind Cap	DNK4218
22	Flexible Cable (25P)	DDD1323	58	Terminal Screw	AKE-031-0
23	Flexible Cable (7P)	DDD1326	59	Screw	BBZ30P060FTB
24	Flexible Cable (12P)	DDD1327	60	Screw	BBZ30P080FTC
25	Flexible Cable (6P)	DDD1328	61	Screw	BCZ30P080FTB
26	Flexible Cable (7P)	DDD1329	62	Screw	BPZ30P080FTB
27	Flexible Cable (10P)	DDD1333	63	Screw	CCZ30P060FTB
△ 28	AC Inlet Assy	See Contrast table (2)	64	Flange Nut M7	DBN1011
29	Flexible Cable (24P)	DDD1330	65	Screw	IBZ30P080FTB
30	Connector Assy(10P-12P)	DKP3763	66	Nut	NKX2FTC
31	Connector Assy	PF05EE-S22	67	Screw	PMH30P100FTB
32	Connector Assy	PF05EE4S32	68	Screw	PMH40P080FTC
33	Connector Assy	PF06EE-D12	69	Binder (SKB-90BK)	ZCA-SKB90BK
NSP 34	Rear Panel	See Contrast table (2)	NSP 70	Caution LABEL	See Contrast table (2)
35	Bracket TRIM	DNF1728	NSP 71	Earth LABEL	See Contrast table (2)
36	Bracket SSW	DNF1729			

(2) CONTRAST TABLE

DJM-800/WYXJ5, /TLXJ and DJM-800/KUCXJ are constructed the same except for the following :

Mark	No.	Symbol and Description	DJM-800 /KUCXJ	DJM-800 /WYXJ5	DJM-800 /TLXJ
△	28	AC Inlet Assy	DKP3761	DKP3762	DKP3762
NSP	34	Rear Panel	DNC1800	DNC1789	DNC1791
NSP	55	LABEL	DRW2294	DRW2293	DRW2319
NSP	70	Caution LABEL	DRW1975	Not used	Not used
NSP	71	Earth LABEL	DRW2276	Not used	Not used

2.3 CONTROL PANEL SECTION

A
B
C
D
E
F

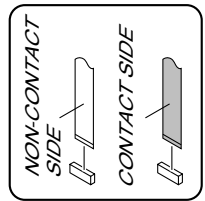
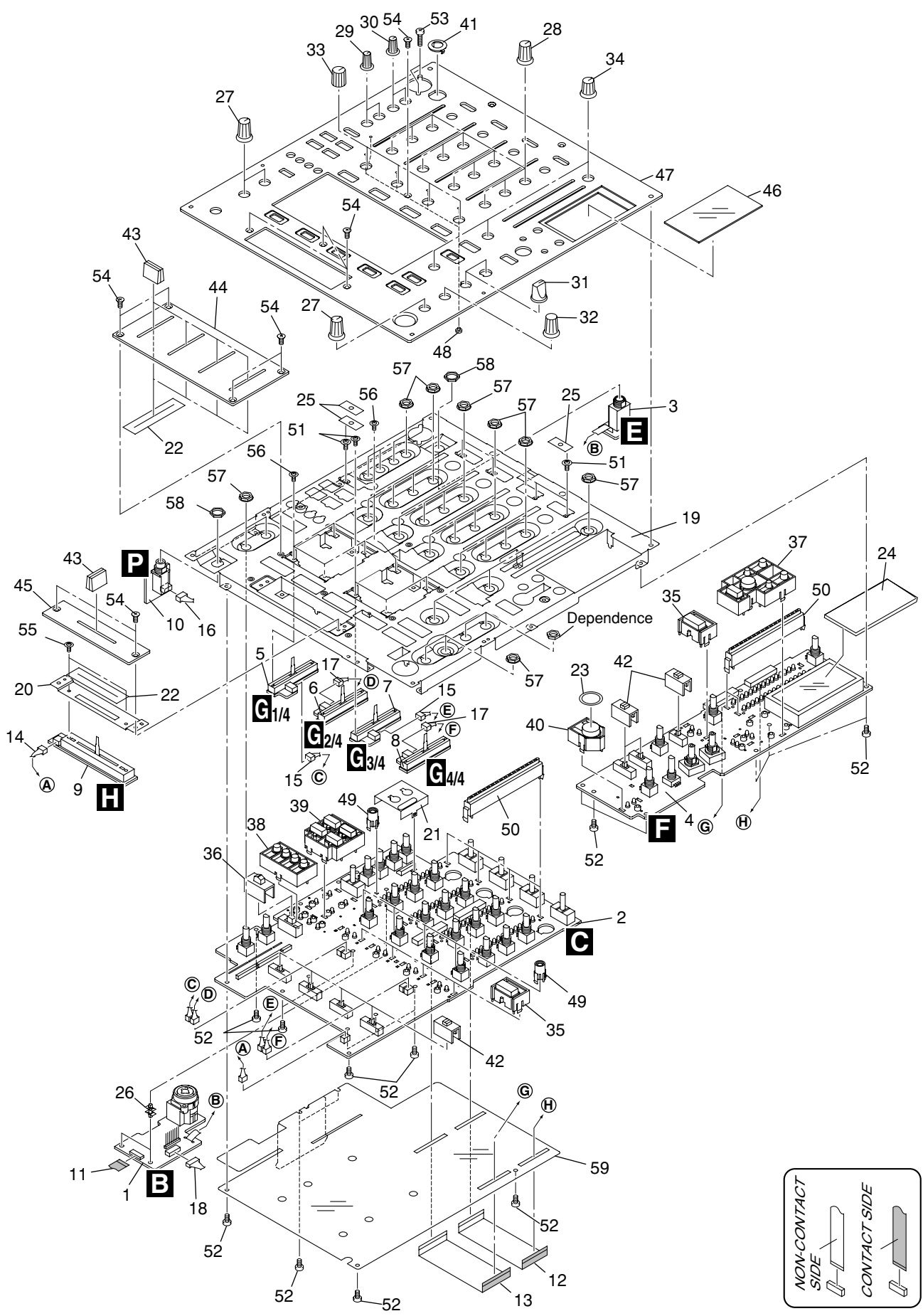

5
CONTROL PANEL SECTION PARTS LIST

<u>Mark No.</u>	<u>Description</u>	<u>Part No.</u>
1	MIC 1 Assy	DWX2542
2	PANEL 1 Assy	DWX2552
3	MIC 2 Assy	DWX2543
4	PANEL 2 Assy	DWX2554
5	CHFD 1 Assy	DWX2537
6	CHFD 2 Assy	DWX2538
7	CHFD 3 Assy	DWX2539
8	CHFD 4 Assy	DWX2540
9	CRSFD Assy	DWX2541
10	HP JACK Assy	DWX2553
11	Flexible Cable (12P)	DDD1320
12	Flexible Cable (27P)	DDD1324
13	Flexible Cable (30P)	DDD1325
14	Housing Wire Assy	PF03PP-D12
15	Housing Wire Assy	PF04PP-D05
16	Housing Wire Assy	PF04PP-D20
17	Housing Wire Assy	PF04PP4D05
18	Housing Wire Assy	PF05FF-D25
NSP 19	Panel Stay	DND1254
20	CRF Stay	DNF1726
21	MIC Stay	DNF1727
22	Fader Packing	DEC2903
23	SW Packing	DEC2929
24	Barrier (FL)	DEC2943
25	SW Packing	DED1177
NSP 26	PC Support	VEC1508
27	Rotary SW Knob (A)	DAA1175
28	Rotary SW Knob (B)	DAA1176
29	Rotary SW Knob S (A)	DAA1177
30	Rotary SW Knob S (B)	DAA1178
31	Select Knob	DAA1205
32	Rotary SW Knob (C)	DAA1180
33	Rotary SW Knob (HM)	DAA1197
34	Rotary SW Knob (MA)	DAA1198
35	CUE Knob	DAC2215
36	Slide SW Cap (A)	DAC2219
37	SET Knob (TAP)	DAC2300
38	SET Knob (FS)	DAC2301
39	SET Knob (HM)	DAC2302
40	EFFECT Knob	DAC2304
41	MIC Cap	DAC2309
42	Slide SW Cap	DAC2310
43	Slider Knob (L2)	DAC2371
44	CHF Panel	DAH2426
45	CRF Panel	DAH2427
46	Disply Panel	DAH2428
47	Control Panel	DNB1144
48	LENS	DNK4532
49	LENS Holder	DNK4533

<u>Mark No.</u>	<u>Description</u>	<u>Part No.</u>
50	LEVEL Meter Assy	DXB1882
51	Screw	AMZ26P040FTC
52	Screw	BBZ30P060FTB
53	Screw	BPZ30P120FTB
54	Screw	CCZ30P060FTB
55	Screw	DBA1262
56	Screw	DBA1298
57	Flange Nut M9	DBN1008
58	Nut	NKX2FTC